

KINGPINLESS STYLE 61 SERIES



FEATURES

Swivel Section: A high alloy steel swivel section features a precision machined and through hardened 3-1/4" diameter raceway with 1/2" inch ball bearings.

Legs: 5/16" x 2-1/2" legs are formed and continuously welded inside and outside to the yoke base.

Kingpin: Kingpinless style design.

Axle: 3/4" diameter.

Lubrication: Pre-lubricated before shipping.

Wheels: 4" to 12" diameter wheels are available.

Finish: Clear zinc plating.

APPLICATIONS

Excellent for light powered applications, bakery dough troughs, portable work benches, platform trucks, tow lines, utility carts, tooling fixtures, scrap metal carriers, drywall dollies, gantry cranes, automated guided vehicles, fiberglass lay-up molds, and other applications.

BENEFITS

The 61 Series kingpinless style swivel bearings act as both load and thrust components and lock the swivel section together to distribute the load over a larger area. The single ball race design provides easy maneuverability and longevity under high load situations.

OPTIONS

BRAKES

Cam: C*
 Poly Lock: P*
 Wrap Around: W*
 Dual Side: DS
 Single Side: SS
 Face Contact: F

SWIVEL LOCKS

Factory Installed: L
 Demountable: DL
 Foot Actuated: KL
 Passive: PL

SEALED SWIVEL SECTION SSW

SEALED WHEELS SW

TOE GUARD TG

* For wheels with a diameter > 6"
 ^ Only available on roller bearing wheels.

KINGPINLESS STYLE 61 SERIES

STRAIGHT ROLLER BEARING

Diameter	Width	Material	Capacity	OAH	Swivel Radius	Swivel Lead	Part Number	Weight
4	3.00	Cast Iron	2,000	5.62	3.81	1.50	61-04301-10-1	18.00
4	3.25	Standard Polyurethane	1,200	5.62	3.86	1.50	61-04321-60-1	16.00
5	2.50	Cast Iron	2,000	6.50	4.43	1.75	61-05251-10-1	20.00
5	2.50	Standard Polyurethane	1,325	6.50	4.43	1.75	61-05251-60-1	20.00
5	3.00	Standard Polyurethane	1,550	6.50	4.51	1.75	61-05301-60-1	22.00
6	2.50	Cast Iron	2,500	7.50	5.40	2.25	61-06251-10-1	22.50
6	2.50	Forged Steel	3,500	7.50	5.40	2.25	61-06251-20-1	22.00
6	2.50	Phenolic Resin	1,600	7.50	5.40	2.25	61-06251-30-1	14.50
6	2.50	Standard Polyurethane	1,625	7.50	5.40	2.25	61-06251-60-1	26.00
6	2.50	Mold On Rubber	550	7.50	5.40	2.25	61-06251-70-1	24.00
6	3.00	Cast Iron	2,500	7.50	5.46	2.25	61-06301-10-1	23.00
6	3.00	Phenolic Resin	2,000	7.50	5.46	2.25	61-06301-30-1	17.00
6	3.00	Standard Polyurethane	2,050	7.50	5.46	2.25	61-06301-60-1	15.00
6	3.00	H.D. Standard Polyurethane	2,450	7.50	5.46	2.25	61-06301-65-1	14.50
6	3.00	Mold On Rubber	675	7.50	5.46	2.25	61-06301-70-1	23.00
8	2.50	Phenolic Resin	2,000	10.12	6.37	2.25	61-08251-30-1	17.00
8	2.50	Standard Polyurethane	2,050	10.12	6.37	2.25	61-08251-60-1	23.00
8	2.50	H.D. T/R Polyurethane	1,640	10.12	6.37	2.25	61-08251-66-1	25.00
8	2.50	Mold On Rubber	670	10.12	6.37	2.25	61-08251-70-1	19.00
8	3.00	Forged Steel	3,500	10.12	6.43	2.25	61-08301-20-1	29.00
8	3.00	Cast Iron	3,500	10.12	6.43	2.25	61-08301-10-1	39.00
8	3.00	Phenolic Resin	2,500	10.12	6.43	2.25	61-08301-30-1	19.00
8	3.00	Standard Polyurethane	2,520	10.12	6.43	2.25	61-08301-60-1	27.00
8	3.00	H.D. Standard Polyurethane	3,100	10.12	6.43	2.25	61-08301-65-1	25.00
8	3.00	H.D. T/R Polyurethane	2,500	10.12	6.43	2.25	61-08301-66-1	25.00
8	3.00	Mold On Rubber	840	10.12	6.43	2.25	61-08301-70-1	24.00
10	3.00	Cast Iron	3,500	11.50	8.14	3.00	61-10301-10-1	42.00
10	3.00	Phenolic Resin	2,900	11.50	8.14	3.00	61-10301-30-1	21.00
10	3.00	Standard Polyurethane	3,000	11.50	8.14	3.00	61-10301-60-1	32.00
10	3.00	H.D. Standard Polyurethane	3,500	11.50	8.14	3.00	61-10301-65-1	37.00
10	3.00	H.D. T/R Polyurethane	2,750	11.50	8.14	3.00	61-10301-66-1	37.00
10	3.00	Mold On Rubber	1,000	11.50	8.14	3.00	61-10301-70-1	37.00
12	3.00	Phenolic Resin	3,500	13.50	9.12	3.00	61-12301-30-1	30.00
12	3.00	Standard Polyurethane	3,500	13.50	9.12	3.00	61-12301-60-1	41.00
12	3.00	Mold On Rubber	1,125	13.50	9.12	3.00	61-12301-70-1	32.00

Capacity listed is for manual operation. For powered operations, consult factory.

Part Numbers listed are for the swivel caster.

For rigid casters, change series to 65 and change the last digit from 1 to 2 (i.e. 65-10309-60-2).

Estimated weight is for swivel caster. Deduct 20 percent of swivel caster weight for rigid casters.

*These casters have precision ball bearings.

All dimensions are in inches. All weights are in pounds.

CONTINUED

MAXIMUM CAPACITY
3,500 lbs.

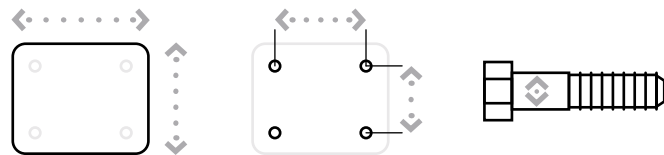

Top Plate Size	Bolt Hole Spacing	Bolt Diameter
Standard: 4.5" x 6.25"	2.438" x 4.938" Slotted to 3.375" x 5.25"	0.5"
Optional Top Plate 70: 5" x 7.25"	3.375" x 5.25" Slotted to 4.125" x 6.125"	0.5"
Optional Top Plate 75: 6" x 7"	4.625" x 5.5"	0.5"
Optional Top Plate 80: 6" x 7.5"	4.5" x 6"	0.5"

Note: OT 80 will increase OAH by 1/8"

61 SERIES TOP PLATE

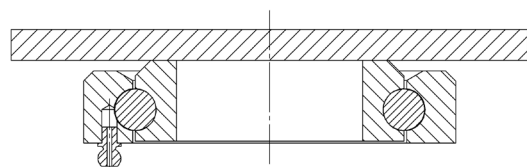

KINGPINLESS STYLE 61 SERIES

PRECISION BEARING

Diameter	Width	Material	Capacity	OAH	Swivel Radius	Swivel Lead	Part Number	Weight
4	3.00	Cast Iron	2,000	5.62	3.81	1.50	61-04309-10-1	18.00
4	3.25	Standard Polyurethane	1,200	5.62	3.86	1.50	61-04329-60-1	16.00
5	2.50	Cast Iron	2,000	6.50	4.43	1.75	61-05259-10-1	20.00
5	2.50	Standard Polyurethane	1,325	6.50	4.43	1.75	61-05259-60-1	20.00
5	3.00	Standard Polyurethane	1,550	6.50	4.51	1.75	61-05309-60-1	22.00
6	2.50	Cast Iron	2,500	7.50	5.40	2.25	61-06259-10-1	22.50
6	2.50	Forged Steel	3,500	7.50	5.40	2.25	61-06259-20-1	22.00
6	2.50	Phenolic Resin	1,600	7.50	5.40	2.25	61-06259-30-1	14.50
6	2.50	Standard Polyurethane	1,625	7.50	5.40	2.25	61-06259-60-1	26.00
6	2.50	Mold On Rubber	550	7.50	5.40	2.25	61-06259-70-1	24.00
6	3.00	Cast Iron	2,500	7.50	5.46	2.25	61-06309-10-1	23.00
6	3.00	Phenolic Resin	2,000	7.50	5.46	2.25	61-06309-30-1	17.00
6	3.00	Standard Polyurethane	2,050	7.50	5.46	2.25	61-06309-60-1	15.00
6	3.00	H.D. Standard Polyurethane	2,450	7.50	5.46	2.25	61-06309-65-1	14.50
6	3.00	T/R Polyurethane	1,640	7.50	5.46	2.25	61-06302-61-1*	14.50
6	3.00	Mold On Rubber	675	7.50	5.46	2.25	61-06309-70-1	23.00
8	2.50	Phenolic Resin	2,000	10.12	6.37	2.25	61-08259-30-1	17.00
8	2.50	Standard Polyurethane	2,050	10.12	6.37	2.25	61-08259-60-1	23.00
8	2.50	H.D. T/R Polyurethane	1,640	10.12	6.37	2.25	61-08259-66-1	25.00
8	2.50	Mold On Rubber	670	10.12	6.37	2.25	61-08259-70-1	19.00
8	3.00	Forged Steel	3,500	10.12	6.43	2.25	61-08309-20-1	29.00
8	3.00	Cast Iron	3,500	10.12	6.43	2.25	61-08309-10-1	39.00
8	3.00	Phenolic Resin	2,500	10.12	6.43	2.25	61-08309-30-1	19.00
8	3.00	Standard Polyurethane	2,520	10.12	6.43	2.25	61-08309-60-1	27.00
8	3.00	T/R Polyurethane	2,000	10.12	6.43	2.25	61-08302-61-1*	27.00
8	3.00	H.D. Standard Polyurethane	3,100	10.12	6.43	2.25	61-08309-65-1	25.00
8	3.00	H.D. T/R Polyurethane	2,500	10.12	6.43	2.25	61-08309-66-1	25.00
8	3.00	Mold On Rubber	840	10.12	6.43	2.25	61-08309-70-1	24.00
10	3.00	Cast Iron	3,500	11.50	8.14	3.00	61-10309-10-1	42.00
10	3.00	Phenolic Resin	2,900	11.50	8.14	3.00	61-10309-30-1	21.00
10	3.00	Standard Polyurethane	3,000	11.50	8.14	3.00	61-10309-60-1	32.00
10	3.00	T/R Polyurethane	2,400	11.50	8.14	3.00	61-10302-61-1*	32.00
10	3.00	H.D. Standard Polyurethane	3,500	11.50	8.14	3.00	61-10309-65-1	37.00
10	3.00	H.D. T/R Polyurethane	2,750	11.50	8.14	3.00	61-10309-66-1	37.00
10	3.00	Mold On Rubber	1,000	11.50	8.14	3.00	61-10309-70-1	37.00
12	3.00	Phenolic Resin	3,500	13.50	9.12	3.00	61-12309-30-1	30.00
12	3.00	Standard Polyurethane	3,500	13.50	9.12	3.00	61-12309-60-1	41.00
12	3.00	Mold On Rubber	1,125	13.50	9.12	3.00	61-12309-70-1	32.00

Capacity listed is for manual operation. For powered operations, consult factory.

Part Numbers listed are for the swivel caster. For rigid casters, change series to 65 and change the last digit from 1 to 2 (i.e. 65-10309-60-2).

Estimated weight is for swivel caster. Deduct 20 percent of swivel caster weight for rigid casters.

*These casters have precision ball bearings.

All dimensions are in inches. All weights are in pounds.



HEAVY DUTY 65 SERIES CASTERS