

General Duty Series

PSQ30119ZN-3H

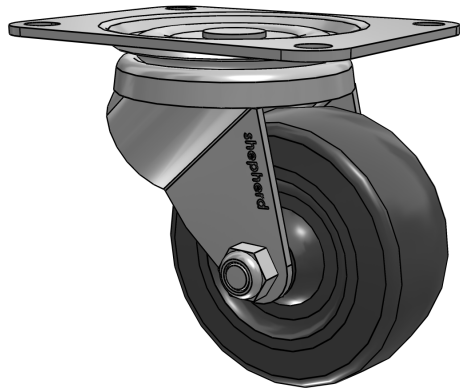

*Interactive 3D graphic, click to activate and rotate.
(3D capable PDF viewer required)*

Technical Details	
Part Number	PSQ30119ZN-3H
Series	General Duty Series
Mounting Options	Top Plate Swivel
Wheel Diameter [INCH]	3
Plate Size	4-1/8" x 3-1/8"
Bolt Spacing/Bolt Hole	2-3/8" x 3-3/8" to 3-7/16" (for 5/16" bolt)
Tread Width [INCH]	1 1/4
Tread Type	Hard Rubber (Dark Grey)
Finish	Zinc
Dynamic Load [Pounds]	225
Caster Brake	Without Brake
Mounting Height [INCH]	3 13/16
Swivel Radius [INCH]	2 5/8

Shepherd

As a leading designer of light-duty and low-profile casters, Shepherd has pioneered innovations that have revolutionized industries. With single and twin-wheel casters customizable for performance, aesthetics, or cost —Shepherd's continued focus on design and quality is what sets a Shepherd caster apart from the competition. Caster products range from 40 to 1,000 lbs. per caster, and feature an industry leading selection of fastenings, finishes, and brakes.

Standard Features

- Economical, single raceway mobility solution
- Large formed raceway helps distribute load shocks
- Nickel plated kingpin for smooth swivel action
- RoHS compliant zinc plating for added corrosion resistance
- Available in various sizes ranging from 2" to 4" wheel diameters
- Swivel, rigid, and brake options for all sizes and wheel types
- Nut and bolt axle standard



Shepherd
203 Kerth Street
Saint Joseph, MI 72401

1-800-253-0868
www.shepherdcasters.com

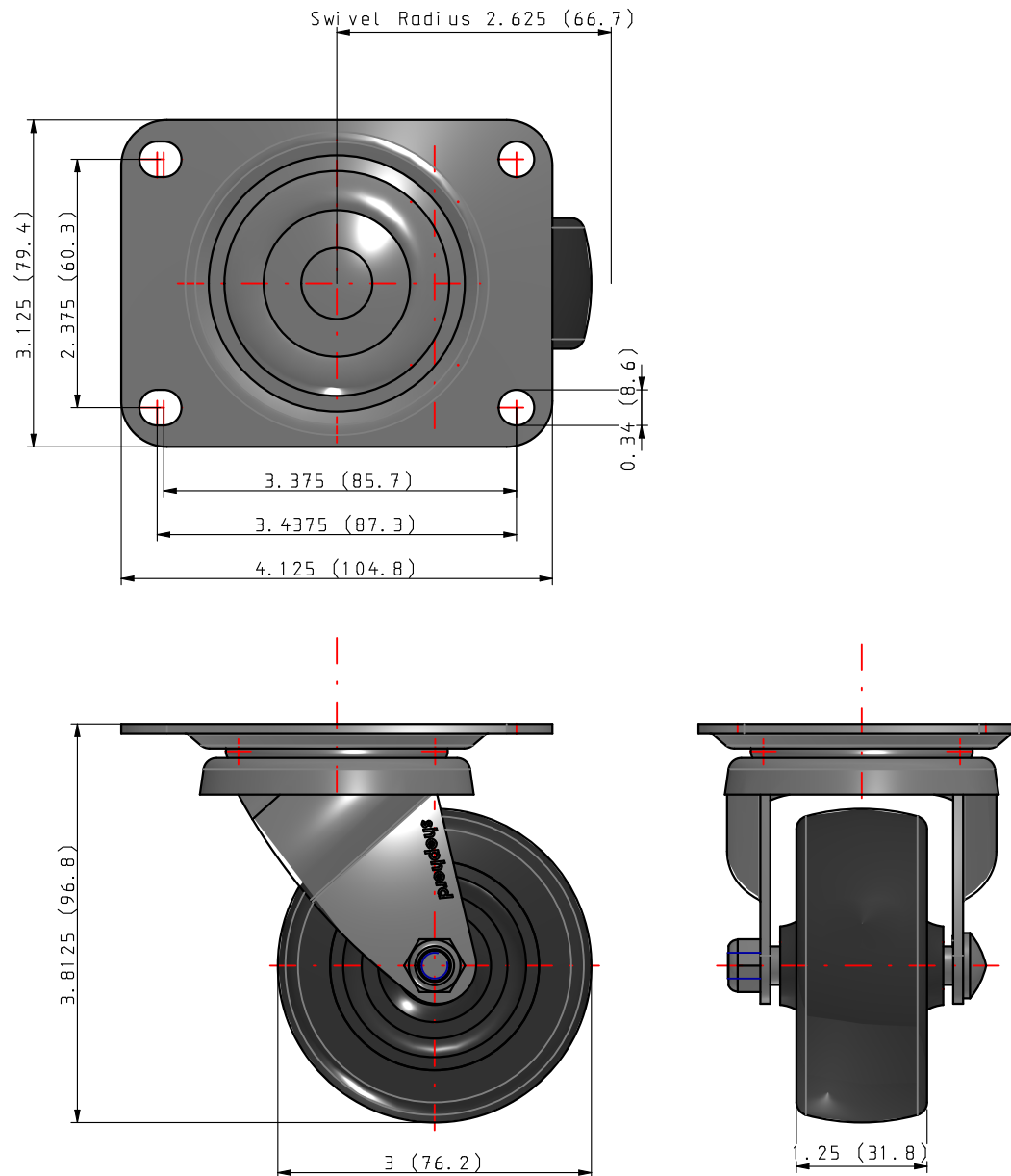

Part Number:

PSQ30119ZN-3H

Series:

General Duty Series

Brand:

Shepherd

Shepherd

203 Kerth Street • Saint Joseph, MI 49085

Phone: 1-800-253-0868

Website: www.shepherdcasters.com